

OREGON PUBLIC LAND CORNER REPORT / RESTORATION REPORT
Tillamook County Surveyor's Office

SECTION: 33, 34, 4 and 3	TOWNSHIP: 1 and 2 South	RANGE: 9 West
COUNTY: Tillamook		DATE: 4/2022
CORNER DESIGNATION: Section corner common to sections 33 and 34, Township 1 South, Range 9 West, and Sections 4 and 3, Township 2 South, Range 9 west		(Please check one)
		<input type="checkbox"/> Condition Report Only
		<input checked="" type="checkbox"/> Restoration
		<input type="checkbox"/> Rewitness
		<input type="checkbox"/> Unrecorded
		<input type="checkbox"/> Reset
<input type="checkbox"/> Referenced Out		

Previous Rewitnesses, Restorations and Surveys, etc: B-1206, B-1044, A-4003, A-4049, A-4051, B-2815 and B-3301.

History, condition, and sources: 1856 GLO surveyor Snowden - Set post and marked 4 Crabapple BT's. 1896 County surveyor A.M. Austin started at the corner, see survey for W.M. Johnson recorded in Book S3 and A.M. Austin field book 1, pages 64-83. 1929-1930 County surveyor W.E. Anderson tied section corner, see map F-23-07 and field book 43, page 77. 1941 J.H. Scott tied the section corner, see map F-17-18. 1951 County surveyor, W.E. Anderson, found 3/4" pipe for section corner, see map B-301. 1965 county surveyor J.L. Carlich, S.A. Skinner and G. Arthur found old corner post, broke off and lying in the field. They re-established the section corner from the 1/4 corner to the South, using the bearings and distance on map B-301, see rewitness in Book 5, Page 118. They set a 2 1/2" iron pipe 22 feet West of the fence corner and marked 1 new BT. 1974 G. Arthur and Dan McNutt found the 2 1/2" iron pipe and Spruce BT. They replaced the iron pipe with a Tillamook County Brass Cap in concrete in tile, see rewitness card #259. 1975 A. Duncan, CS, found the brass cap to be in the wrong place by tying the 1/4 corner common to Sections 34 and 3 (1/2 mile to East). Duncan re-established the section corner to be 22.30 feet East of the brass cap, in a corner fence post. Duncan re-marked the brass cap as RM 1 and set RM 2 36.85 feet South, see revised rewitness card #259 (note that I could not find the Tippin field notes). I re-established the Section corner at record distance from the two RM's. The corner fence post is now rotted off, so I set a 1 1/2" x 30" iron pipe with a 3" Tillamook County Surveyor brass cap stamped as shown, in concrete, top 3" above the ground. I tied the Section corner 1 mile to the North and the 1/4 corners 1/2 mile to the West, South and East and the distances fit well with record ties.

Found (Rewitness card 259 pg. 2) reference monument 1 stamped "T1S R9W RM # 1 SEC COR 22 30 RS 287 1975" (N 88° W 22.30')
Now N 89° 05' 21" W 22.30'

Found (Rewitness card 259 pg.2) reference monument 2 stamped "RM #2 SEC COR 36 85 RS 287 1975" (South 36.85') **Now** S 0° 3' 15" W 36.85'

Found (Rewitness card 259 pg. 2) Bearing Tree for RM #1 (24" Spruce with face S 88° E 435.80') **Now** 48" with healed face S 89° 25' 21" 435.1' set 80D nail on the South-center of tree

New accessories set:

1 1/2" galvanized iron pipe with 3 1/2" Tillamook County Surveyor Brass cap stamped as shown, under old rotted off corner fence post, at record distance-distance from the two reference monuments.

Hat section post with yellow metal location tag 2' East

48" Spruce with a healed face and a white metal tag marked "do not cut"
S 89° 05' 21" E 412.8'

The Monument was tied directly using G.P.S. The coordinates have been converted and are provided here in WGS 84, Latitude and Longitude.

Latitude: 45° 26' 02"
Longitude: 123° 46' 58"

Pictures of Found Monuments:



Location: Section corner is at the north end of Baumgartner Rd (now a cow lane) in an East-West Fence line

Tillamook County Surveyor office: 1510 3rd Street Suite C, Tillamook, OR. 97141

Party Chief: Terry Jones, P.L.S. 2507, Survey Supervisor

Witnesses: Michael Rice, P.L.S. 86926, Tillamook County Surveyor
Travis Porter, Survey Tech.

Notes: Digital images taken of the monument and accessories.

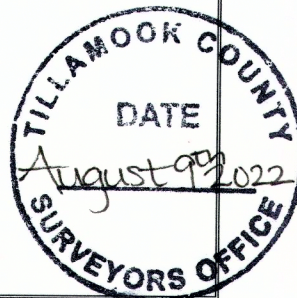

SURVEYOR'S SEAL

REGISTERED
PROFESSIONAL
LAND SURVEYOR

Terry J. Jones

OREGON
JULY 25, 1991
TERRY L. JONES
2507
RENEWAL DATE: JUNE 30, 2023